

# FOR SALE

## COMMERCIAL - LIGHT INDUSTRIAL (B1) 2,347SQFT (218SQM) / CALL FOR PRICE!

+65 9021 6006



Flexi Suite

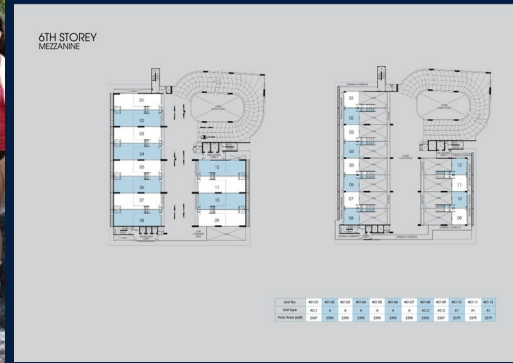

### COMMERCIAL - LIGHT INDUSTRIAL (B1) INSPACE, 24, NEW INDUSTRIAL ROAD, HOUGANG, SINGAPORE 536210

- LISTING ID: SGLD08655971
- TENURE: FREEHOLD
- TITLE: N/A
- SIZE BUILT-UP: 2,347SQFT (218SQM)
- SIZE LAND: 1.431AC (0.579HA)
- NO. OF FLOORS: 8
- FLOOR/LEVEL: N/A - N/A
- PARKING SPACES: N/A
- LAYOUT TYPE: OTHER
- FACING: N/A
- VIEWING: N/A
- SELLING PRICE: **CALL FOR PRICE!**
- COMPLETION YEAR: 2022
- CONDITION: ORIGINAL CONDITION
- LISTING DATE: JUL 04, 2019

### INSPACE

INSPACE is a rare investment opportunity — a prime and centrally-located strata-titled freehold B1 space. Complete with recreational facilities and social amenities, it is a space designed to cater for the new wave of businesses. Its modern, timeless architecture captures the spaciousness that the 84 units provide. 24 New Industrial Road is set to be the next inspiring business address.

### INTERIOR FACILITIES

- Air-Conditioning

### EXTERIOR FACILITIES

- 24 Hours Security
- Pavilion
- Pool Deck
- BBQ (Area / Pavilion)

VISIT THIS PROPERTY AT: <https://www.newsgohomes.com/property/SGLD08655971>

### RAYMOND CHONG - HUTTONS ASIA PTE LTD

3 Bishan Place #05-01 CPF Bishan Building  
D20, 579838, Singapore

+65 9021 6006  
WhatsApp Me

chongraymond@outlook.sg

<https://www.newsgohomes.com>



Scan QR Code

Call for Viewing  
+65-90216006