

FOR SALE

COMMERCIAL - LIGHT INDUSTRIAL (B1) 3,057SQFT (284SQM) / CALL FOR PRICE!

+65 9021 6006



Garden Suite

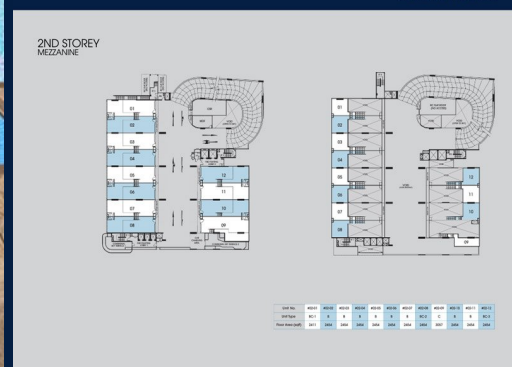

COMMERCIAL - LIGHT INDUSTRIAL (B1)

INSPACE, 24, NEW INDUSTRIAL ROAD, HOUGANG,
SINGAPORE 536210

- LISTING ID: SGLD38167660
- TENURE: FREEHOLD
- TITLE: N/A
- SIZE BUILT-UP: 3,057SQFT (284SQM)
- SIZE LAND: 1.431AC (0.579HA)
- NO. OF FLOORS: 8
- FLOOR/LEVEL: N/A - N/A
- PARKING SPACES: N/A
- LAYOUT TYPE: OTHER
- FACING: N/A
- VIEWING: N/A
- SELLING PRICE: **CALL FOR PRICE!**
- COMPLETION YEAR: 2022
- CONDITION: ORIGINAL CONDITION
- LISTING DATE: JUL 04, 2019

INSPACE

INTERIOR FACILITIES

- Air-Conditioning

EXTERIOR FACILITIES

- 24 Hours Security
- Pavilion
- Pool Deck
- BBQ (Area / Pavilion)

VISIT THIS PROPERTY AT: <https://www.newsgohomes.com/property/SGLD38167660>

RAYMOND CHONG - HUTTONS ASIA PTE LTD

3 Bishan Place #05-01 CPF Bishan Building
D20, 579838, Singapore

+65 9021 6006
WhatsApp Me

chongraymond@outlook.sg

<https://www.newsgohomes.com>



Scan QR Code

Call for Viewing
+65-90216006